



ories By Murray



Sumner County Schools

Capital & Athletic Facility Update

Capital Projects by School Community

2013-2023



Sumner County New School Construction (2016-2023)

Burrus ES	\$14.1 million
Liberty Creek HS	\$84 million
Liberty Creek ES	\$20.6 million
Liberty Creek MS	\$37.2 million
White House Intermediate	\$28.4 million

Comparison to Other School Districts

James Lawson HS (Metro)	\$124 million
Westside ES (Rutherford)	\$57.4 million
Westside MS (Rutherford)	\$71 million
Laguardo ES (Wilson)	\$52.2 million
Green Hills HS (Wilson)	\$107 million

\$184.3 million
in New School Construction

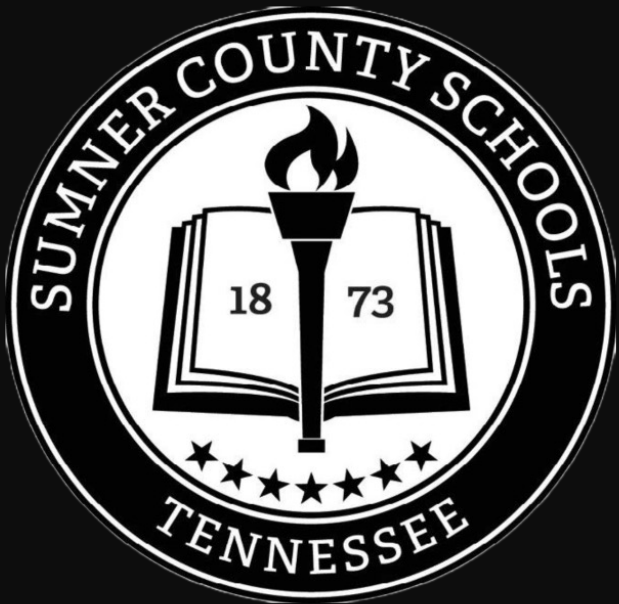

Sumner County School Renovations & Additions (2013-2023)

Beech HS	\$12.9 million
George Whitten ES	\$4.1 million
Gene Brown ES	\$3.2 million
Gallatin HS	\$4.7 million
Guild ES	\$5.0 million
Vena Stuart ES	\$1.8 million
Hendersonville HS	\$7.6 million
Hawkins MS	\$3.5 million
Nannie Berry ES	\$1.9 million
Walton Ferry ES	\$3.4 million
Clyde Riggs ES	\$3.1 million
Watt Hardison ES	\$3.1 million

Jack Anderson ES	\$2.5 million
Station Camp MS	\$3.1 million
White House HS	\$6.9 million

\$66.8 million
in renovations and additions
across Sumner County

BHS School Capital Projects

District:	\$850,000
School/Community:	\$783,439

- Football Field Turf
- Audio System Upgrade (Stadium & Gym)
- Football Scoreboard & Marquee
- Soccer sprinkler system/field upgrades
- Soccer bleachers, concrete, and fencing
- Baseball Field Turf/Field Upgrades
- Baseball Concession Building
- Softball Fieldhouse HVAC
- Campus Fencing
- Annex Gym Bleachers





GHS School Capital Projects

District:	\$850,000
School/Community:	\$373,337

Football Fieldhouse Renovation
Pressbox Renovation
Concession Stand
Ticket Booth
Home Football Bleacher Wrap
Visitor Football New Bleachers
Softball Field & Pressbox
Front Office Flooring
Gym Floor Refinish
Football Stadium Renovations

2 Reel Mowers
Girls Bball Locker Room
Renovation
Football PA System
Softball Scoreboard
Weight Room Renovation
New UTV
Ice Machine
Soccer Locker Room
Renovation

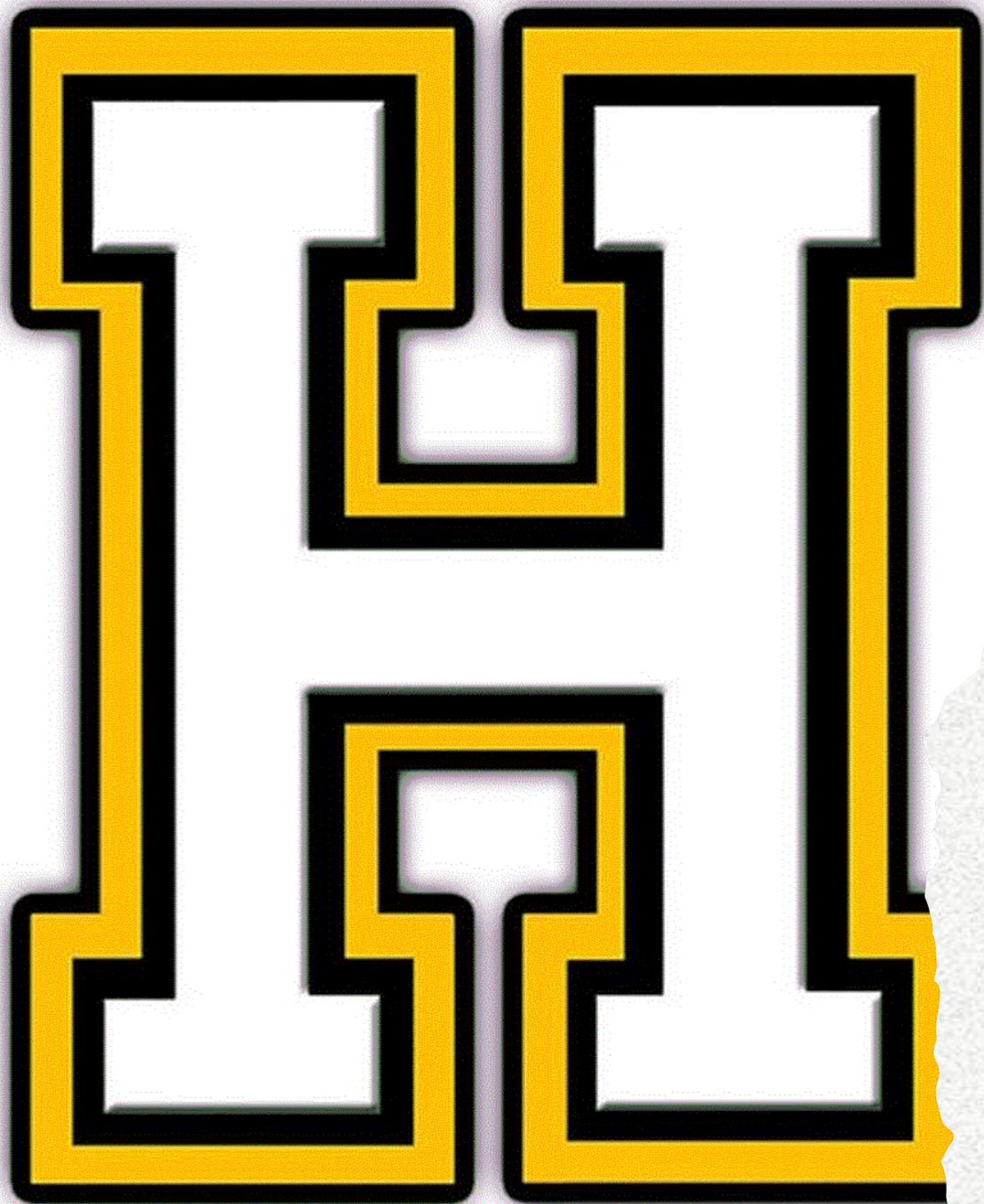

HHS School Capital Projects

District: \$750,000
School/Community: \$205,732

- Football pressbox renovation
- Stadium Ornamental Fencing
- Football LED Scoreboard
- Sound System Upgrade (FB, BB, Café)
- Auditorium Lighting & Sound
- Basketball Scorer's Table
- Gym Upgrade
- Music/Library Furniture
- Wrestling Mats
- Laundry Machines
- Office & Classroom Furniture

MHMS School Capital Projects

District:

\$850,000

-
- New gym floor
 - Fencing
 - Soccer field renovation
 - Upstairs carpet
 - Marquee sign
 - Library shelving & furniture
 - Stage curtains
 - ES Entrance
 - Elevator
 - Locker Room HVAC
 - Campus-wide paving
-





PHS School Capital Projects

District:

\$850,000

- Football facility indoor turf
- Football lockers
- Line striping machine
- Softball field renovations
- Softball scoreboard
- Soccer field renovations
- Soccer sound system upgrade
- LED videoboard in gym
- Gym sound system
- Library furniture & flooring
- Auditorium lights & curtains
- Office/Classroom/Café Furniture
- Band instruments

Station Camp HS School Capital Projects

District:

\$850,000

School/Community:

\$331,102

- Soccer fieldhouse

Gym floor refinish

Gym bleacher renovation

Basketball scoreboard

Baseball scoreboard

Baseball field turf

Football scoreboard

Gator

Reel mower
- Zero turn mower

Tennis court renovation

Wrestling mats

Band equipment

Library furniture

Café furniture





WHS School Capital Projects

District: \$850,000
School/Community: \$330,000

Football scoreboard	Outdoor eating area
Football fieldhouse	Guidance furniture
Storage building	Auditorium carpet
Pressbox renovation	
Baseball pressbox	
Baseball infield turf	
Baseball bleachers/concrete	
Softball pressbox	
Softball field renovations	
Softball batting cage	
Gym floor refinish	
Basketball scoreboard	



WHHS School Capital Projects

District:

\$850,000

- New gym floor
- Auditorium lighting/sound/video/curtains
- Baseball scoreboard
- Softball scoreboard
- Soccer scoreboard
- Baseball indoor turf
- Football fieldhouse renovations
- Football field paving & fence
- Mower & reel mower
- LED marquee sign
- Annex library flooring & furniture
- Classroom furniture
- Guidance furniture
- Band instruments
- Annex guidance flooring
- STEM & Graphix lab furniture

Current & Upcoming Capital Projects

2023-2024



Sumner County Capital Budget (2023-2024)

School Capital Projects	\$6.11 million
Instruction (Textbooks/Technology)	\$4.33 million
New school buses	\$1.84 million
Furniture/Furnishings	\$2.10 million
Building Construction	\$2.94 million
Data Processing	\$750,000
Site Development	\$1.6 million
Safety	\$715,000

\$20.4 million
in School/District Capital Projects

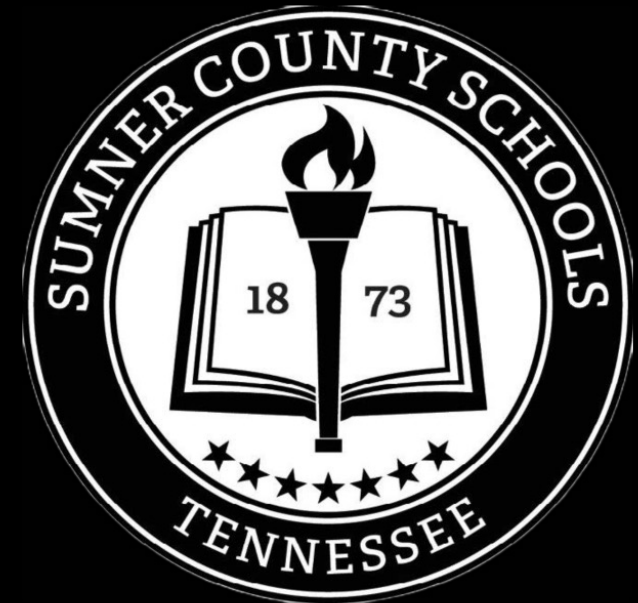

Sumner County School Capital Projects (2023-2024)

PHS Roof	\$1.17 million	BHS Annex HVAC	\$1.1 million
MCE Gutters	\$50,000	White House Annex HVAC	\$325,000
MCE HVAC Controls	\$59,000	WHHS White Building HVAC	\$150,000
MCE Cafeteria HVAC	\$35,000	PWM Awning	\$25,000
SCH Roof	\$131,000	GHS Little Gym/Auditorium	\$300,000
SCH Flooring	\$274,500	HVAC	
SCH Gym Floor	\$145,000	MS/ES Capital Projects List	\$450,000
SCH/RSM LED Lights	\$615,000	HS Capital	\$540,000
WMS Cooling Tower	\$210,000		
NBE HVAC Controls	\$202,000		
WHE Asphalt	\$8,000		
MHMS Paving	\$300,000		

Phase 1

Complete by July 31, 2024





296 days

Bleacher Replacement Steps

Demolition

Geotechnical Study

Survey

Civil-Site Design

Architectural Renderings/Design

Purchasing (Purchasing Contracts or Bids)

School Board Approval

**These steps must be
completed prior to
getting bids!**

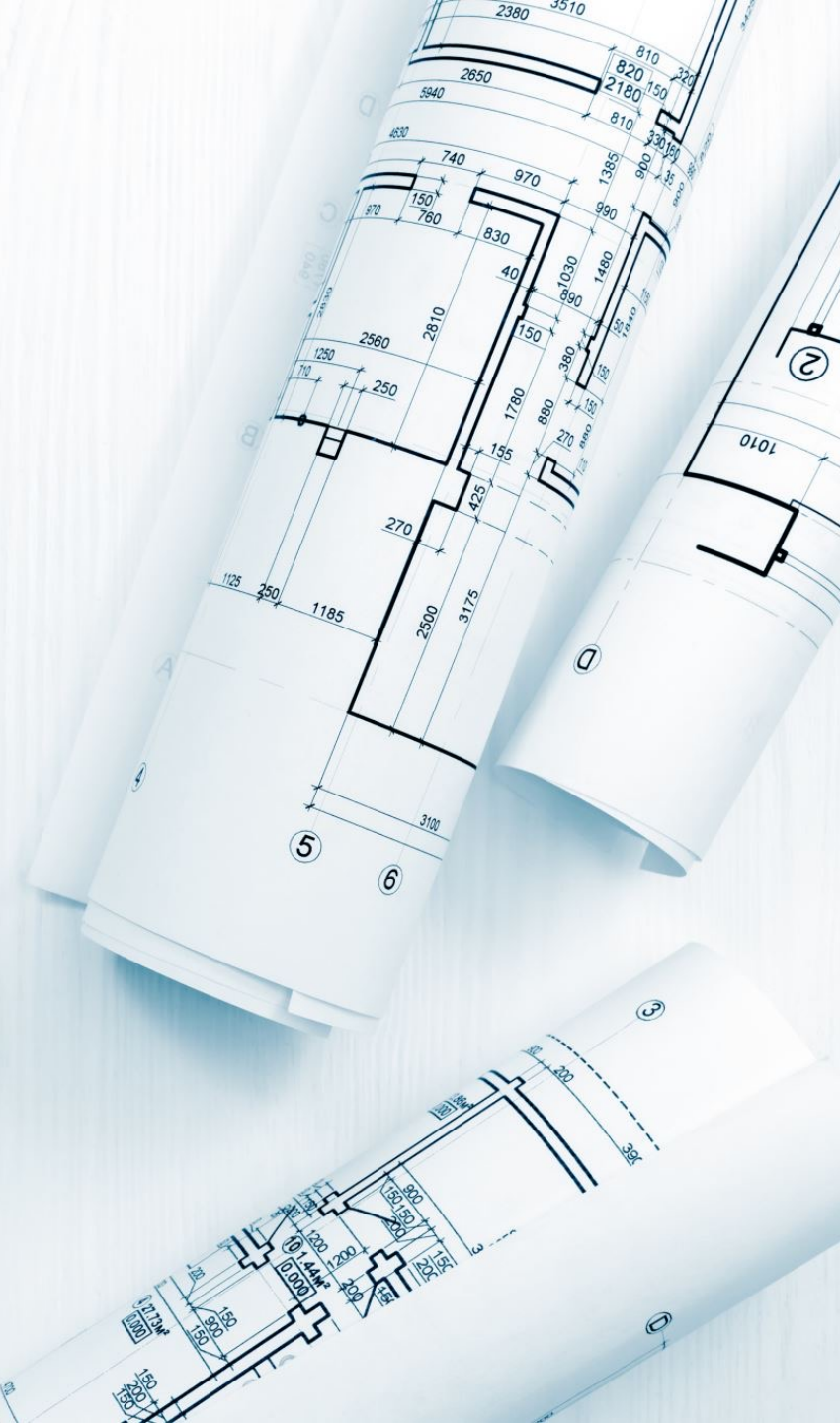

A blue and yellow excavator with "DEMOLITION" and "4500" written on its side is shown working on a pile of rubble and debris. The excavator's arm is raised, and it appears to be in the process of demolishing a structure. The background is a clear blue sky.

Demolition

- BHS Home
- HHS Home & Visitor
- PHS Home & Bathrooms
- GHS Home (2023 or 2024)

Demo to begin after last home game.

Geotechnical Report

A subsurface soil testing and exploration analysis. It is crucial to understand the soil mechanics of a site to design a suitable foundation for a structure.



A photograph of two construction workers on a job site. They are wearing hard hats and high-visibility safety vests. One worker is holding a clipboard and they both appear to be looking at the plans together. The background shows a construction site with rebar and a city skyline in the distance.

Civil-Site Design

Civil site design identifies and addresses potential problems and includes items such as permitting, subsurface characteristics, and zoning.



Architectural Plans

The architect draws plans and supervises the project working to develop the specifications, ensuring bids are done timely and properly, and ensuring construction is done timely and correctly.



A high-angle, slightly blurred photograph of two people shaking hands over a wooden desk. The person on the right is wearing a yellow hard hat and a red and white plaid shirt. The person on the left is wearing a dark blue long-sleeved shirt. On the desk, there is a laptop, a tablet displaying charts, a calculator, a ruler, and some papers. The background is a light-colored wall.

Bidding/Pricing

Once planning is completed, the projects will be put out for sealed bid. This process will take *at least a month*. Contractors will need to do a site assessment prior to bidding and to prepare their bids.

Ensuring contractors have proper paperwork, bonds, insurance.

Construction

- Site preparation
- Piers
- Arrival of steel and bleachers
- Construction



Comparison

GHS visitor side bleachers were approved by the school board in August 2022 and were completed July 2023.

Time is of the essence to have bleachers replaced by August 2024!



Beech High School

Phase 1

- New home and visitor bleachers
- Accessible facilities for all fans
- Restrooms
- Dressing Areas
- Pressbox
- Athletic Trainer Room
- Offices
- Concession Stand
- Ticket Office/Entry
- Infrastructure for new track





Gallatin High School

Phase 1-2

- New Home bleachers
- New Pressbox
- New Lighting
- New Dressing Areas/Restrooms
- Entrance updates
- On Campus Track
- Or consideration of an on-campus stadium w/ track

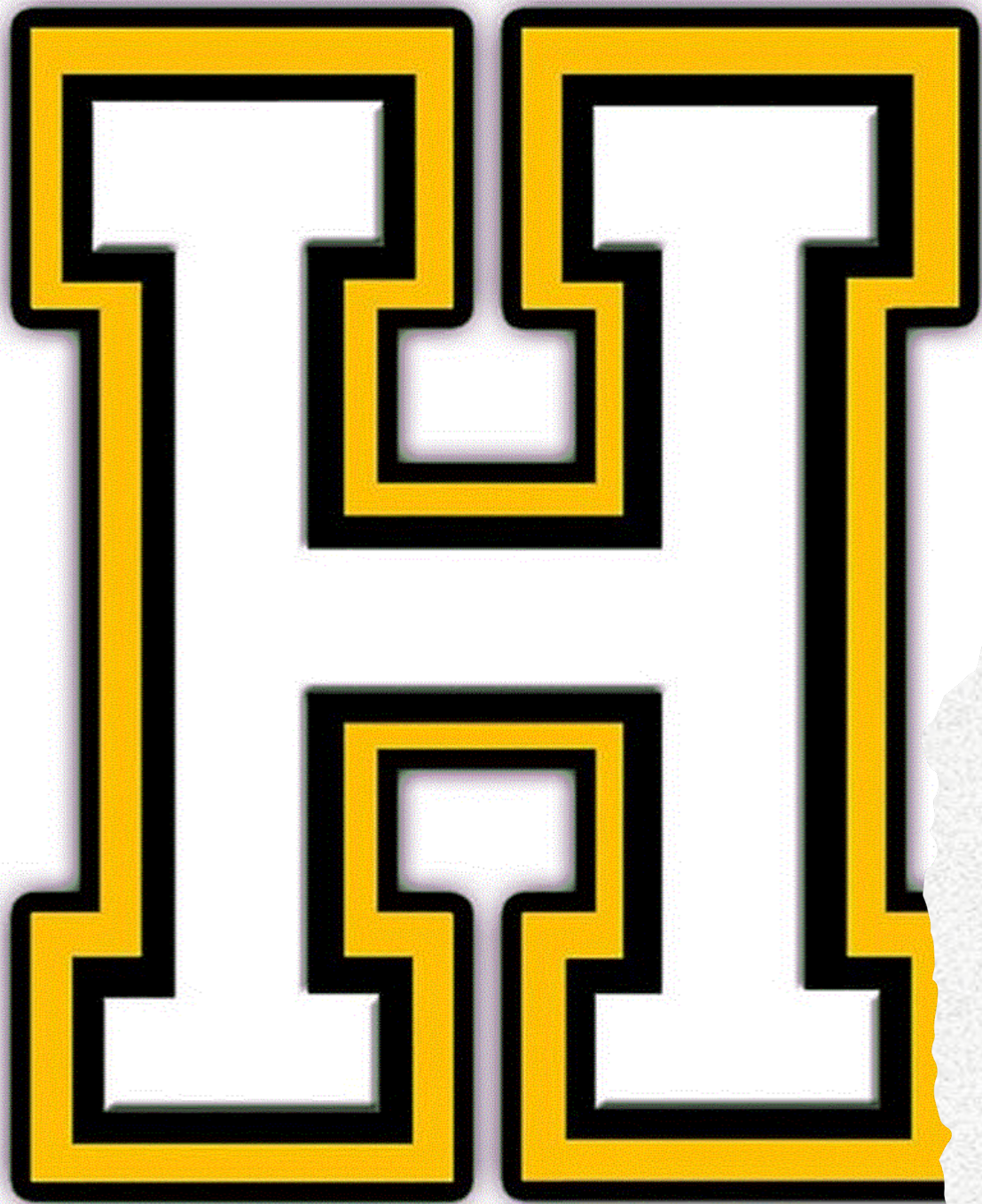

Hendersonville High School Phase 1

- New home and visitor bleachers
- Visitor dressing area
- Visitor pressbox
- Visitor side storage areas
- Home: Athletic trainer room
- Home: Offices & storage areas
- Brick to match current facade

Merrol Hyde Magnet School Phase 1

- Upgrade athletic trainer room
 - Upgrade training space
 - Site work/Study for 4 tennis courts
 - Study for gym renovation/updating.
-





Portland High School Phase 1

- New home bleachers
 - New restroom facilities
 - Pressbox
 - Lighting
 - Infrastructure for track and on-campus stadium
-

Station Camp HS Phase 1

- Preparation for field turf
- Preparation for new track
- New basketball court
(Separate funding source)





Westmoreland HS Phase 1

- Athletic Trainer Room & Office Renovations
 - Prep/infrastructure for field turf
 - Prep/infrastructure for track
 - Prep/infrastructure for soccer field
-

White House HS Phase 1

- Repairs to existing stadium bleachers
 - Preparation work for new, on-campus stadium (August 2025 opening)
 - Preparation work for on-campus track
-



Phase 2

July 31, 2025/Long-Term



Beech High School Phase 2

- Complete track & field
- Soccer/Baseball restrooms
- Fan accessibility to fields
- On-campus softball field





Gallatin High School Phase 2

- Baseball/softball facility
- Athletic trainer room
- Baseball field on campus
- LED lighting on campus
- Renovated on-campus athletic facilities

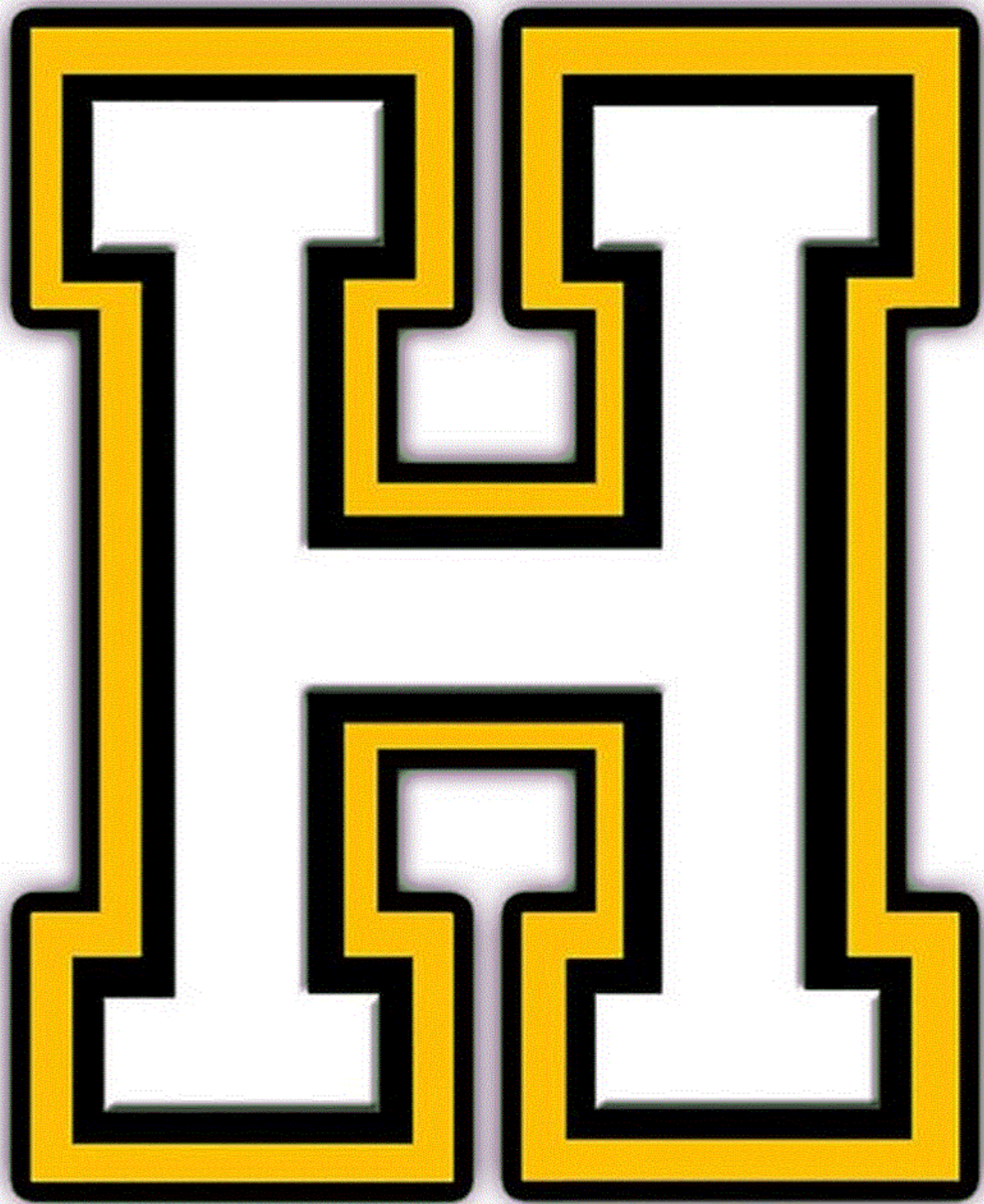

Hendersonville High School

Phase 2

- Additional space for locker rooms and weight rooms
- Renovate field house
- Increased parking
- Additional training space/locker rooms for multiple sports (Dance/Cheer/Lacrosse/Wrestling/ etc.)
- Updated space for JROTC

MHMS Phase 2

- 4 tennis courts with lights
- New gym bleachers
- Expand/renovate soccer concession stand
- Lower gym sound system



Portland High School Phase 2

- Complete on-campus stadium with track
 - Tennis courts (None in Portland)
 - LED lighting on fields
 - Increased parking
 - Soccer building renovation
-



Station Camp HS

Phase 2

- New basketball complex with full-sized gym & seating. Locker rooms & athletic trainer facility.
- Indoor training facility
- Concessions/restroom upgrade
- Entrance to athletic facility
- Expand visitor football bleachers





Westmoreland HS

Phase 2

- Field turf football, baseball, and softball
- LED lighting
- Bathroom facilities at the stadium
- Stadium ornamental fencing
- Paving around the stadium



White House HS Phase 2

- Complete on-campus stadium with track.
- Field turf on field to accommodate multiple sports & band
- Annex gym renovation
- Increased parking